

# USGA RULES GOVERN ALL PLAY

*Except as modified by local rules*

**OUT OF BOUNDS** • Marked by White Stakes.

**LATERAL WATER HAZARDS** • Marked by Red Stakes.

**WATER HAZARDS** • Marked by Yellow Stakes.

**FREE LIFT** • Off all Roads and Paths.

Ground under repair as marked.

## YARDAGES TO GREEN

● 100 Yards

○ 150 Yards

● 200 Yards

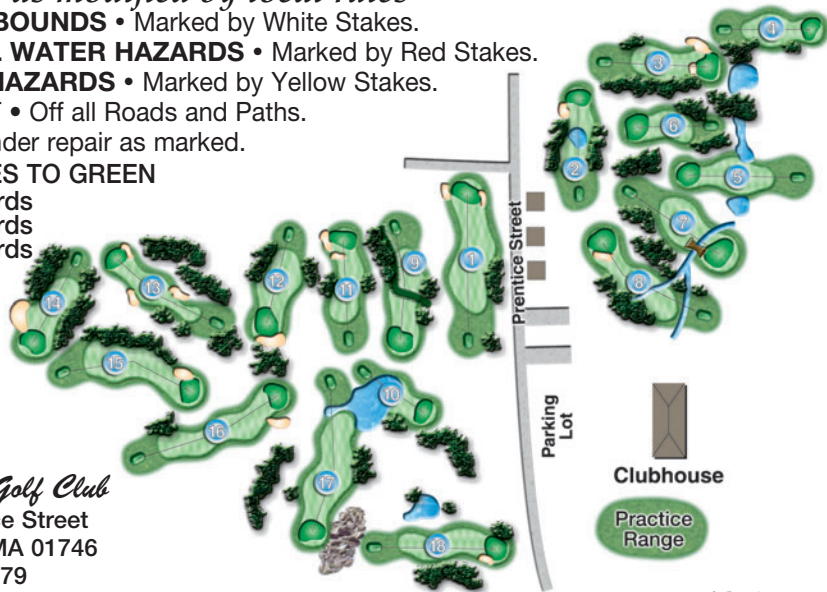

*Pinecrest Golf Club*

212 Prentice Street

Holliston, MA 01746

774-233-0579

[www.pinecrestgolfclub.org](http://www.pinecrestgolfclub.org)

GOLF ASSOCIATES  
(800) 438-8726 3/19



Managed by New England Golf Corporation



[www.newenglandgolfcorp.com](http://www.newenglandgolfcorp.com)

<b>BLUE TEES</b>	<b>398</b>	<b>165</b>	<b>275</b>	<b>153</b>	<b>325</b>	<b>190</b>	<b>317</b>	<b>305</b>	<b>295</b>	<b>2423</b>	<b>165</b>	<b>264</b>	<b>205</b>	<b>472</b>	<b>245</b>	<b>405</b>	<b>305</b>	<b>200</b>	<b>222</b>	<b>2483</b>	<b>4906</b>		
<b>PAR</b>	<b>4</b>	<b>3</b>	<b>4</b>	<b>3</b>	<b>4</b>	<b>3</b>	<b>4</b>	<b>4</b>	<b>4</b>	<b>33</b>	<b>3</b>	<b>4</b>	<b>3</b>	<b>5</b>	<b>4</b>	<b>4</b>	<b>4</b>	<b>3</b>	<b>3</b>	<b>33</b>	<b>66</b>		
<b>HANDICAP</b>	<b>7</b>	<b>15</b>	<b>9</b>	<b>17</b>	<b>3</b>	<b>13</b>	<b>1</b>	<b>5</b>	<b>11</b>		<b>18</b>	<b>16</b>	<b>14</b>	<b>2</b>	<b>12</b>	<b>4</b>	<b>6</b>	<b>8</b>	<b>10</b>				
<b>HOLES</b>	<b>1</b>	<b>2</b>	<b>3</b>	<b>4</b>	<b>5</b>	<b>6</b>	<b>7</b>	<b>8</b>	<b>9</b>	<b>OUT</b>	<b>10</b>	<b>11</b>	<b>12</b>	<b>13</b>	<b>14</b>	<b>15</b>	<b>16</b>	<b>17</b>	<b>18</b>	<b>In</b>	<b>Tot</b>	<b>Hcp</b>	<b>Net</b>
<b>RED TEES</b>	<b>330</b>	<b>135</b>	<b>240</b>	<b>120</b>	<b>274</b>	<b>160</b>	<b>234</b>	<b>275</b>	<b>283</b>	<b>2051</b>	<b>145</b>	<b>251</b>	<b>183</b>	<b>392</b>	<b>223</b>	<b>395</b>	<b>271</b>	<b>120</b>	<b>175</b>	<b>2155</b>	<b>4206</b>		
<b>PAR</b>	<b>4</b>	<b>3</b>	<b>4</b>	<b>3</b>	<b>4</b>	<b>3</b>	<b>4</b>	<b>4</b>	<b>4</b>	<b>33</b>	<b>3</b>	<b>4</b>	<b>3</b>	<b>5</b>	<b>4</b>	<b>4</b>	<b>4</b>	<b>3</b>	<b>3</b>	<b>33</b>	<b>66</b>		
<b>HANDICAP</b>	<b>1</b>	<b>15</b>	<b>13</b>	<b>17</b>	<b>3</b>	<b>11</b>	<b>7</b>	<b>5</b>	<b>9</b>		<b>16</b>	<b>10</b>	<b>14</b>	<b>4</b>	<b>12</b>	<b>2</b>	<b>8</b>	<b>18</b>	<b>6</b>				

DATE:

SCORER:

ATTEST:

Course Rating: 63.2 Slope Rating: 103